



Standard cardboard TUBES. Also available as an option with a valve. The packages are made of cardboard glued with a thickness of ~ 1.1 mm. The interior is lined with aluminum foil. The tubes are equipped with an aluminum membrane with a handle for easy opening. Sold complete with a plastic lid and a metal bottom for self-assembly.



## Standard TUBES

Name Material		diameter (mm)	~73	~99
		height (mm)	~120	~160
TUBES	WHITE (with white lid and a metal bottom)		●	●
		valve	●	●
	ECO (with white lid and a metal bottom)		●	●
		valve	●	●
	BLACK MAT (with black cap and a metal bottom)		●	●
		valve	●	●

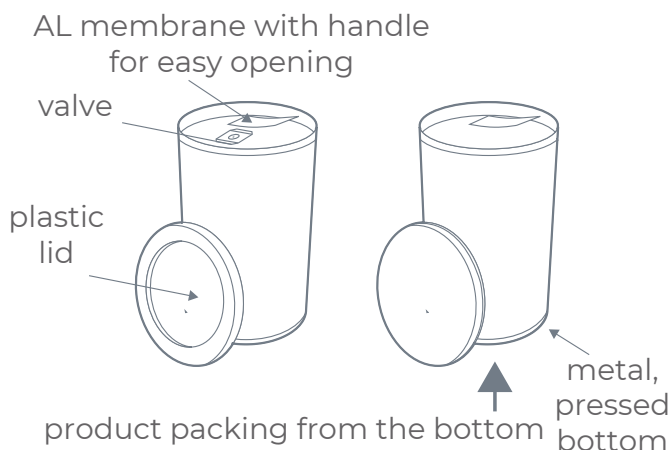

## RELATED SERVICES AND PRODUCTS



Semi-automatic  
closing machine  
cans / tubes ZPP



Automatic closing  
machine  
for cans / tubes AZP/S 30



Packaging line for  
powdery products  
SDP/S 500 A



## CANS / TUBES with imprint

We produce CANS / TUBES according to individual customer requirements. The packages are made of cardboard glued with a thickness of ~ 1.1 mm. The inside of the tubes can be lined with paper, polyethylene foil or aluminum foil. The aluminum foil layer provides excellent barrier properties of the packaging, maintains the aroma and ensures a long shelf life. Tubes can be equipped with an aluminum membrane that provides protection against accidental opening. CANS / TUBES are closed from the top with a lid made of plastic or metal, depending on the customer's needs. From the bottom, they are closed with a press-in bottom or a bottom designed for wrapping on a machine. We make prints on CANS / TUBES up to 8 colors.



### OPTIONS:

#### Printing refinements:

- matte / glossy foil / soft touch / imitation suede (flock)
- hot-stamping
- metallization
- stamping
- prints inside the tubes

#### Internal diameter of the tubes (mm)

28, 40, 45, 50, 60, 70, 73, 74, 80, 82, 85, 92, 99, 103, 120

#### Standard tube heights (mm)

30÷1000

#### Tube heights with made metal closure (mm)

40÷500

## Types of closures

### Plastic closing

Polyethylene lids (put on or pressed) and bottom (pressed).

Available in colors: 

Lids available in options:

- with a dispenser for loose products
- with a handle for easy opening
- "piggy bank" hole



Push-in bottoms available in options:

- standard
- deeper



### Metal closing

Metal lids (put on or pressed) and bottoms.

Available in colors:  - gold  - silver

Lids available in options:

- "piggy bank" hole
- transparent lid with a handle for easy opening
- with laser engraving
- with an embossed logo



Bottoms available in options:

- pressed



- intended for wrapping on the machine.